

TRG4

MAIN FEATURES

- 20A switching capabilities.
- 4.5KV dielectric coil to contacts.
- Heavy load up to 5000VA.
- Applicable to motor switching.
- UL & cUL recognized.

APPLICATIONS

- Air conditioner, Electronic heaters.
- Lamp and Motor control, Microwave oven
- Magnetron control Fax Machine/OA Equipment, etc.

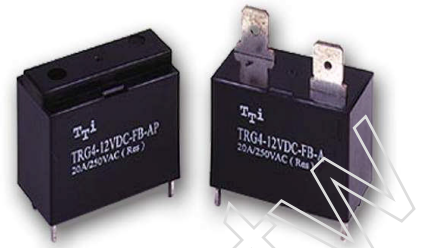

ORDERING INFORMATION

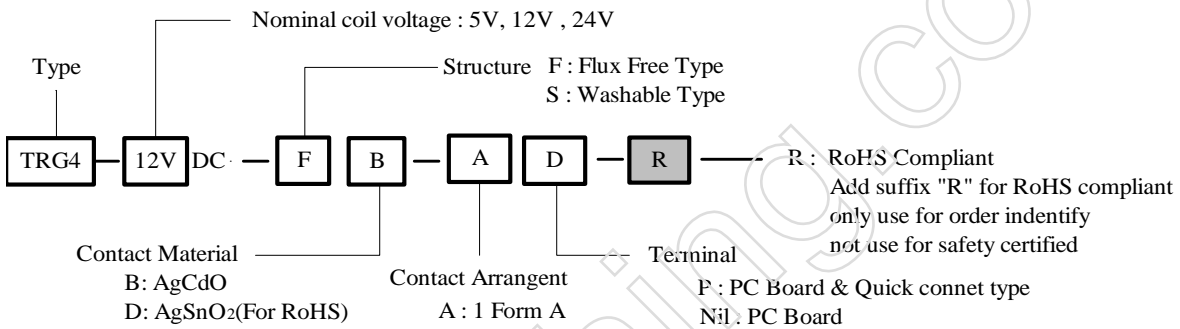

DIMENSION (unit:mm)

DRILLING (unit:mm)

WIRING DIAGRAM

Outline Dimension for TRG4-P

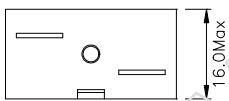

Outline Dimension for TRG4

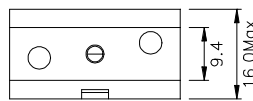

PCB Layout

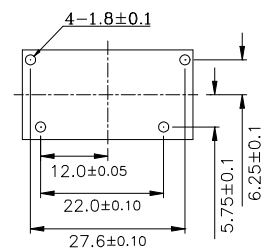

Wiring Diagram

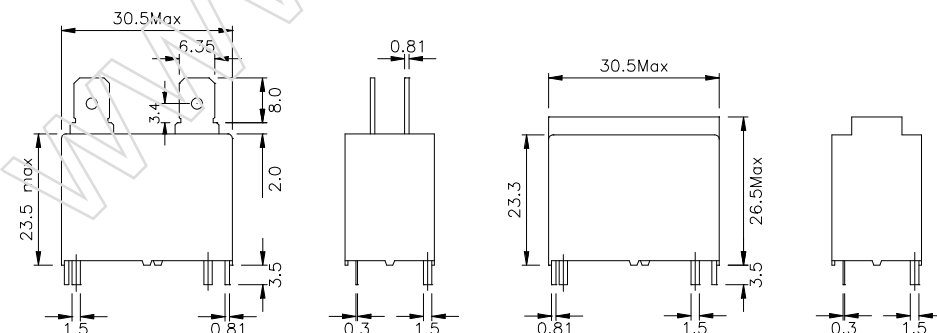
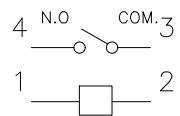

COIL DATA CHART (AT20°C)

Coil Sensitivity	Coil Voltage Code	Nominal Voltage (VDC)	Nominal Current (mA)	Coil Resistance ($\Omega \pm 10\%$)	Power Consumption (W)	Pull-In Voltage (VDC)	Drop-Out Voltage (VDC)	Max-Allowable Voltage (VDC)
TRG4	005	5	179.8	27.8	abt. 0.9W	70% Max.	10% Min.	110% Max.
	012	12	75	160				
	024	24	37.5	640				

CONTACT RATING

Type	TRG4
Item	TRG4
Contact Capacity Resistive Load ($\cos\phi=1$)	20A 250VAC 2HP 240VAC 1HP 120VAC
Inductive Load	Inrush : 80A , 0.3s ($\text{COS}\psi=0.7$) Break : 20A ($\text{COS}\psi=0.9$)
Rated Carrying Current	20A
Max. Allowable Voltage	250VAC
Max. Allowable Current	20A
Max. Allowable Power Force	5000VA
Contact Material	Ag Alloy

REFERENCE DATA

Contact Switching Capacity

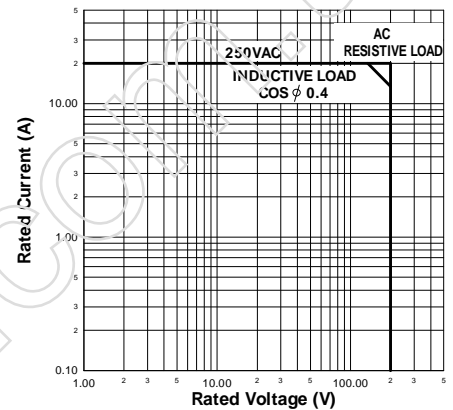

Life Curve

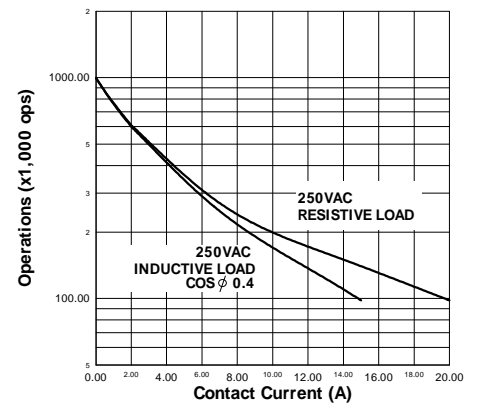

PERFORMANCE (at initial value)

Type	TRG4
Item	TRG4
Contact Resistance	30m Ω Max (measured at: 1A 24VDC).
Operation Time	20msec Max.
Release Time	10msec Max.
Dielectric Strength	Between coil & contact: 4500VAC, 1min Between contacts: 1000VAC, 1min
Insulation Resistance	1000 M Ω Min. (500VDC)
Operating Ambient Temperature	-25°C ~ +55°C
Operating Humidity	85% , +40°C
Vibration Resistance	10 to 55HZ Double Amplitude 1.5mm
Shock Resistance	196 m/s ² Malfunction. 980 m/s ² Mechanical.
Life Expectancy	Mechanically: 2×10^6 ops. Min. (18000PS/h) Electrically: 1×10^5 ops. Min.
Weight	Abt. 23grs.
UL & cUL	E156406

This datasheet for reference and subject to change without notice. Please double check final specification with Tai-Shing.